



Part No. EF50.57020.015

Part No. EG50.57020.015

Description: Energy Regulator

Infinitely variable output from 6% to 70% plus full on position over range
52° to 308° angular anticlockwise increase. Double pole-active and neutral switching.

Application: Hotplate and element control on cookers, grills, urns and heaters.

All applications where output control of a resistive load with anticlockwise rotation for increased output is required.

Specification: D.P.S.T. plus separate pilot switch.

Electrical Rating: Cycling contacts-13 amps, 240 volts A.C., non inductive.

Pilot contacts-0.2 amps, 240 volts A.C.

Wiring diagram in 'O' position:

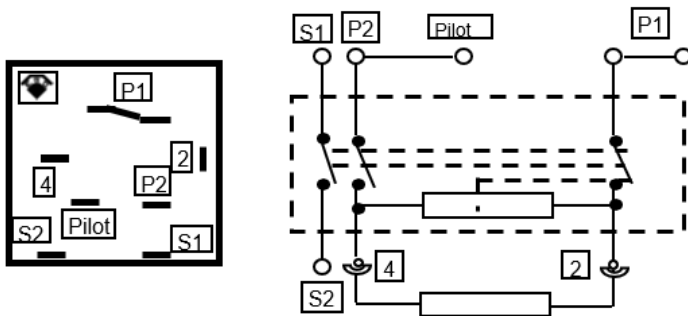

Mounting Dimensions:

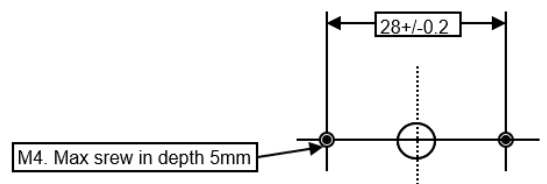

Knob: Use original knob.

Warnings: To be only installed by a Registered Electrician.
Isolate appliance before commencing service.

T: 1800 225 572 | F: 1800 289 723 | E: sales@systemcontrol.com.au | W: systemcontrol.com.au

T: 09 636 1401 | E: sales@systemcontrol.co.nz | W: systemcontrol.co.nz

In support of our policy of continuous product improvement we reserve the right to change materials and specifications without notice. Drawings, where used, are not to scale. All dimensions are in millimetres and sizes given are approximate. Where possible, technical MSDS data sheets are made available on the website. All products should be installed and used in accordance with manufacturer's instructions provided. Warning: products may be the subject of registered designs and patents. Refer to website for terms and conditions on warranty.

