



Part No. EF50.56078.007

Part No. EG50.56078.007

Description: Energy Regulator

Infinitely variable output from 6% to 70% plus full on position over range 45° to 315° angular.

Application: Hotplate and element control on cookers, grills, urns and heaters.
All applications where output control of a resistive load is required.

Specification: S.P.S.T. plus pilot switch

Electrical Rating: Cycling contacts-13 amps, 240 volts A.C., non inductive.
Pilot contacts-0.2 amps, 240 volts A.C.

Original Users:	O.E.M.	Part No.	O.E.M.	Part No.
	Electrolux:	0524 001 596	Roband:	TC0001
	St George:	1236	Birko:	N/A

Standing pilot: Connect jumper wire (supplied) between P1-P2.

Wiring diagram in 'O' position:

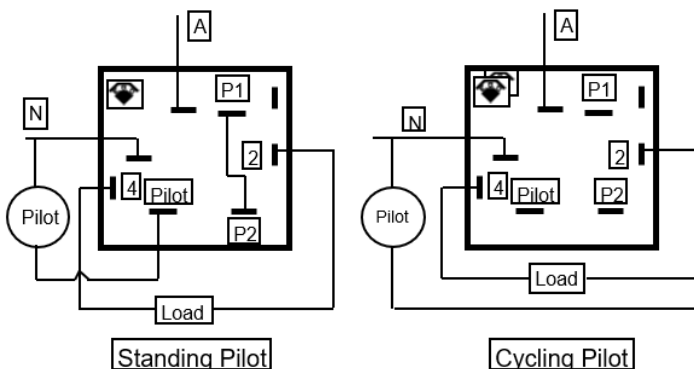

Mounting Dimensions:

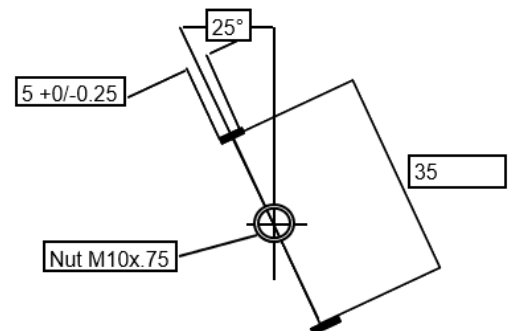

Knob: Use original knob or EF524.100A (Lo,1,2,3,Hi)

Warnings: To be only installed by a Registered Electrician.
Isolate appliance before commencing service.

T: 1800 225 572 | F: 1800 289 723 | E: sales@systemcontrol.com.au | W: systemcontrol.com.au

T: 09 636 1401 | E: sales@systemcontrol.co.nz | W: systemcontrol.co.nz

In support of our policy of continuous product improvement we reserve the right to change materials and specifications without notice. Drawings, where used, are not to scale. All dimensions are in millimetres and sizes given are approximate. Where possible, technical MSDS data sheets are made available on the website. All products should be installed and used in accordance with manufacturer's instructions provided. Warning: products may be the subject of registered designs and patents. Refer to website for terms and conditions on warranty.

